



University of Washington
 Department of Construction Management
 Center for Education and Research in Construction
 New Frontiers Conference
 March 4, 2016

CONFERENCE AGENDA

Time	Event	Location	Presenters/Organizer
Special Breakfast Session (2 nd Floor Foyer) 7:30 - 9:00 a.m.	CIAC Board Meeting	PD Koon Conference	Bill Bender
	Safety & Health	Cornerstone Classroom	Ken-Yu Lin
	Information Exchange	Library	Carrie Sturts Dossick
9:00 - 9:15 a.m.	Opening Remarks	MML	
SESSION 1: 9:15 - 10:30 a.m.	A Health & Safety: Regional Group Network	MML	<u>Organizer:</u> Ken-Yu Lin <u>Presenters:</u> Jia-Hua Lin, Edmund Seto, Giovanni C. Migliaccio
	B Virtual Design & Construction: BIM for Owners	VCL	<u>Organizer:</u> Carrie Sturts Dossick <u>Presenters:</u> Hamid Abdirad, Puyan A. Zadeh, Sheryl Staub-French, Erik A. Poirier
SESSION 2: 10:45 - 12:00 p.m.	A Integration of Modern Technology in Heavy Civil Construction	PD Koon - (2 nd Floor)	<u>Organizer:</u> Kamran M. Nemati <u>Presenters:</u> Julian Yamaura, Mark Holmes, P.E., Kamran M. Nemati
	B Lean Construction	VCL	<u>Organizer:</u> Yong-Woo Kim <u>Presenters:</u> Hyun Woo Lee, Yong-Woo Kim, Jeff Angeley, Chung Ho
12:00 - 12:30 p.m.	Lunch	MML	
12:30 - 1:30 p.m.	Poster Presentation Session	MML	
SESSION 3: 1:45 - 3:00 p.m.	A Sustainable Built Environment	PD Koon - (2 nd Floor)	<u>Organizer:</u> Bill Bender <u>Presenters:</u> Bill Bender, Stacy H Smedley, Hyun Woo Lee,
	B Project Delivery & Management	VCL	<u>Organizer:</u> Giovanni C. Migliaccio <u>Presenters:</u> Steve Harrison, Ahmed M. Abdel Aziz, Giovanni C. Migliaccio
3:00 - 4:00 p.m.	Keynote	MML	Renée Cheng and Markku Allison explore IPD adoption in North America and how it combines with IT and Lean for improved project outcomes
4:00 - 5:30 p.m.	Technology Showcase "All Hands on Tech" Happy Hour with BuiltWorlds	MML	

CONFERENCE MAP

1st Floor

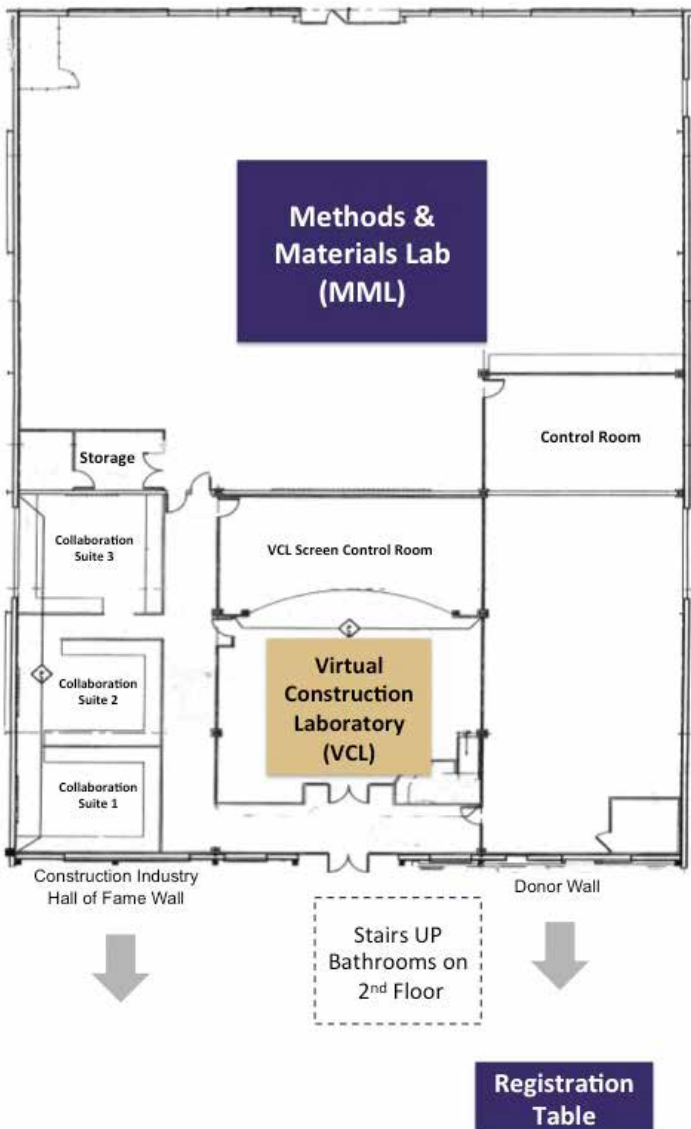

2nd Floor

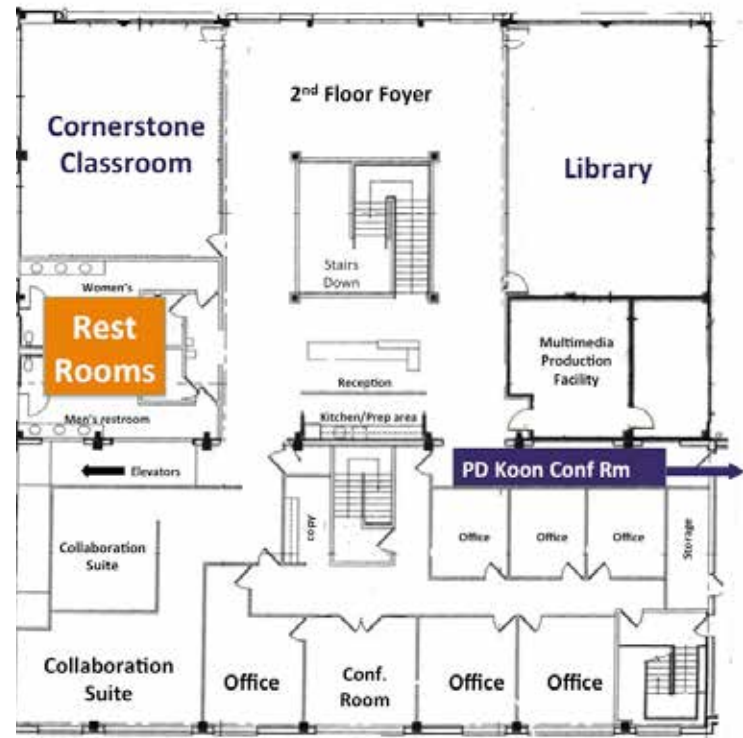

EVENT WiFi: Join the **University of Washington** network, login with UW NetID: **event0897** Password: **37EP=43UZ=23EG**